

Annual report

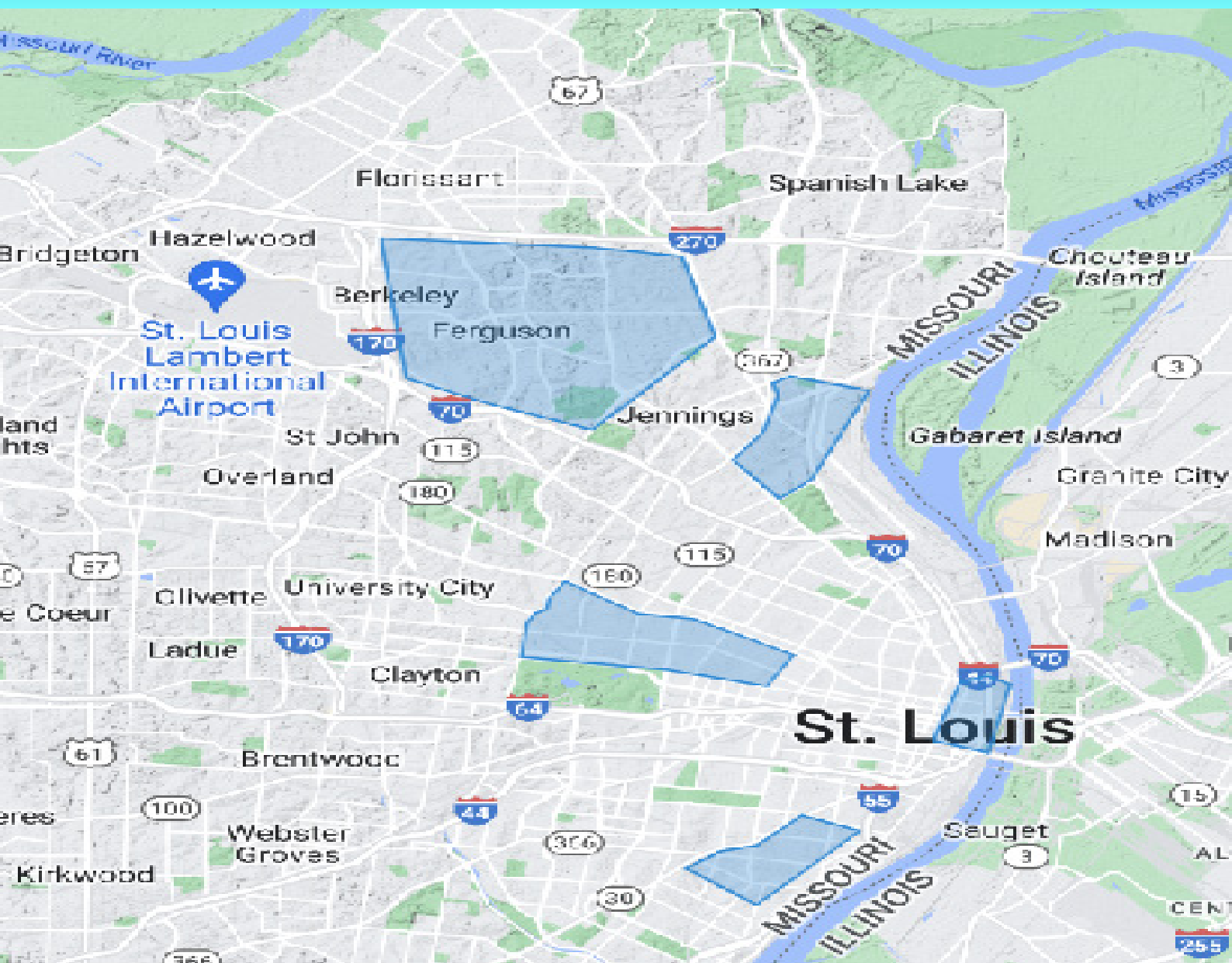

Contents

Chapter 1	1
Chapter 2	2
Chapter 3	3
Chapter 4	4
Chapter 5	5
Chapter 6	6
Chapter 7	7
Chapter 8	8

EXECUTIVE DIRECTOR'S STATEMENT

Our vision is to support the cultural artistic fabric of our community by working with residents to address neighborhood needs through the creative use of skill and skillful use of creativity.

Our mission: St. Louis Arts Chamber of Commerce blends arts and economics for a vibrant community.

In 2024 we now serve five communities including North County, Baden, Delmar Downtown and Gravois Jefferson. We completed our work in Baden with the installation of hte butterfly garden, Little LLibrary, butterfly metomorphosis chart and stepping stones.

We are working on three exhibitions: Mill Creek Valley Commemoration Installation, NEA Big Read program and Your Words STL..

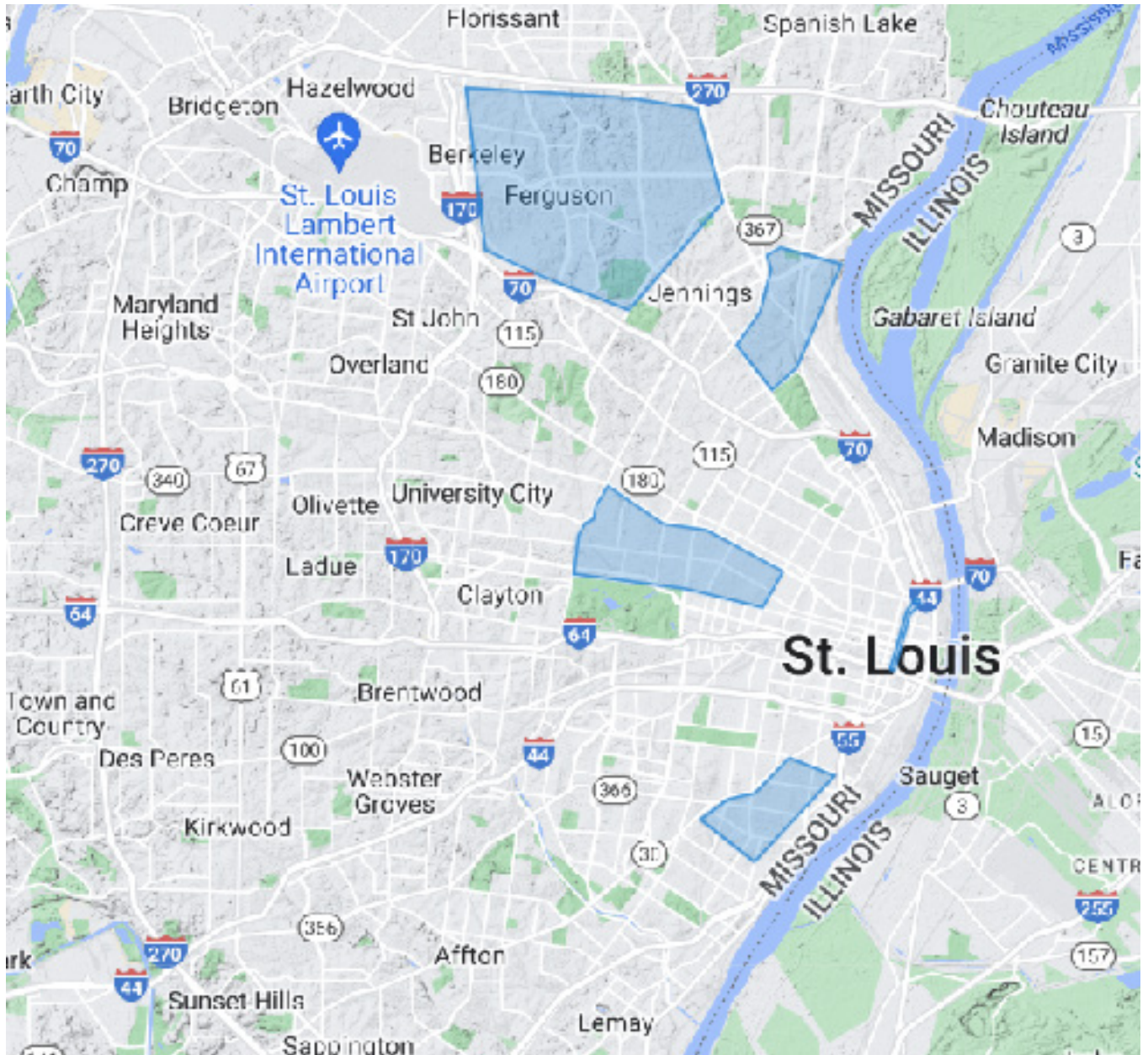

Community engagement: creating economic opportunities for artists



Economic opportunity for artists was fostered through five creative placemaking neighborhood programs as well as three exhibitions begun this year.

Two of the communities in which we work already have their community improvement plans in place and approved by the city. Our work in Baden was focused upon the Lutheran School. Hodiament Tracks engagement was fostered by Great Rivers Greenway and our contribution includes the adjacent parks and artwork,. Finally, we are working actively to created the community engagement in the nine neighborhoods surrounding Delmar. All of the programs included art, cultural and greening initiatives.

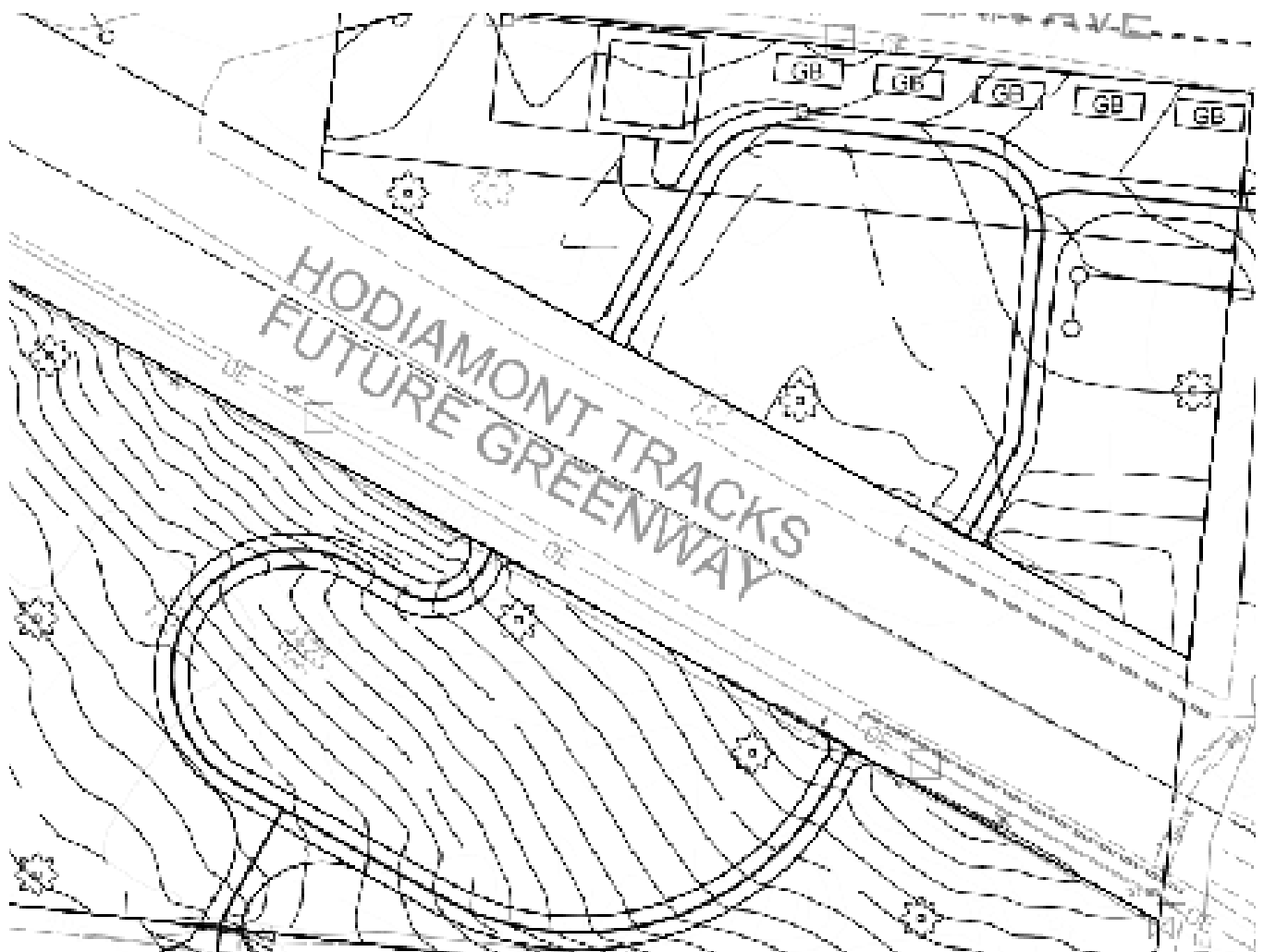

Marquette Park Analysis

Connections . Comfortability . Topographic Changes

Comfortability

There is an abundance of views throughout the site and each station zone provides multiple views of natural viewing. With this in mind, benches are located near the soccer field and good seating areas are shaded along. Many of these views are in poor condition and located topography. These benches and seating areas are in poor condition and located topography. These benches and seating areas are in poor condition and located topography.

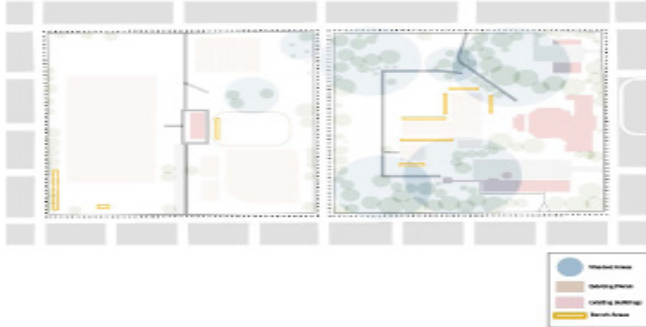

Topographic Changes

There are three primary locations at the park where there are dramatic topographic changes. These points provide different views and experiences that can engage more users and activities. For example, near the soccer playground, the hillside creates a wall that could be transformed into an active space that uses the natural hillside.

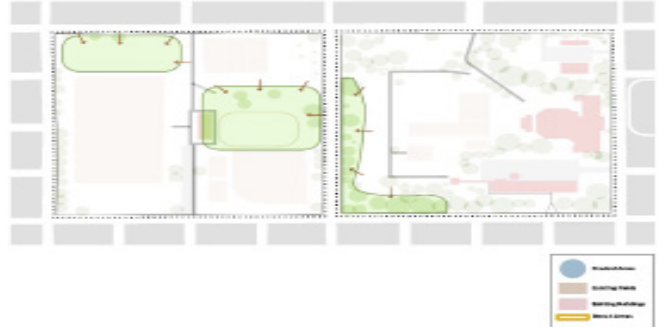

Creative Placemaking

Baden project with River Roads Lutheran School is complete with the installation of the Little Free Library and the butterfly garden.

Hodiamont Lots of Art Project includes the LEwis Place and Vandeventer Parks as well as the Mural Wall and Garden. The Mural Wall is complete and in excellent shape with no graffiti or damage. The Garden has been taken over by an Americorps volunteer. Lewis Place Park engineering has been approved by MSD and is waiting for us to purchase the lots to install the park. Vandeventer Park will be the next engineering project but has a sample design approved by residents. Delmar project is the extension of the Hodiamont Tracks project throughout the nine neighborhoods surrounding Delmar. Community engagement has begun to develop a comprehensive document for the neighborhood projects as well as upgrading Delmar Boulevard itself with the goal to break the Delmar Divide and create a six mile art loop from The Loop on the West through the neighborhoods along Delmar to Grand Center on the east.

Downtown project kicked off with the team from Thanksgiving including the Artori Group. In addition Downtown CID and Greater St. Louis Inc. have joined the team to implement the Design Downtown Plan along Tucker Boulevard.

Gravois Jefferson is our newest partner with art, culture and greenspace projects throughout the three neighborhood area. Our first project is working with the Marquette Park revitalization project to add artistic elements and address the water runoff issues in the park as well as the traffic issues from Compton running through the middle of the park.

Exhibitions and Performances

Three exhibition opportunities began in 2024 to be completed in 2025:

Mill Creek Mural/Installation project: The Mill Creek Valley Commemoration Committee wanted a mural on the northern side of Mill Creek to complement the Pillars on the south side. The project was funded by Regional Arts Commission. A national Call for Art was held and the Commission is pleased with the artist chosen to build the installation at Grand and Lindell, the entrance at the northwest side of Mill Creek.

NEA Big Read grant was funded to create book discussions and events around the book *Sitting Pretty* by Rebekah Taussig. The project focuses the arts on individuals with disabilities.

Your Words STL is a collaboration between Your Words St. Louis, Loyola and Priory to create peace poles along Hodiamont Tracks.

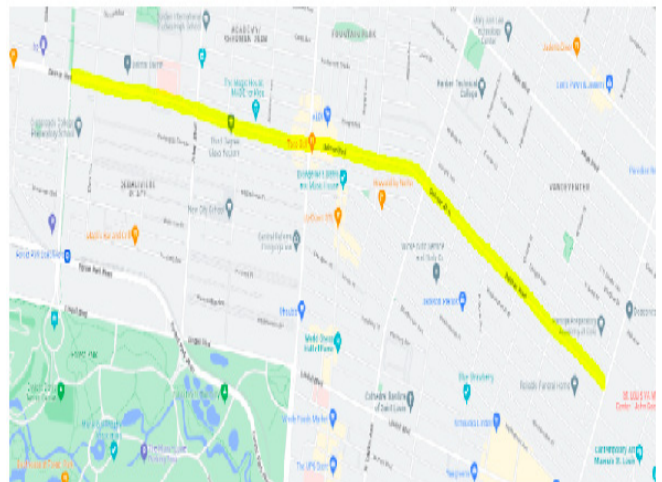
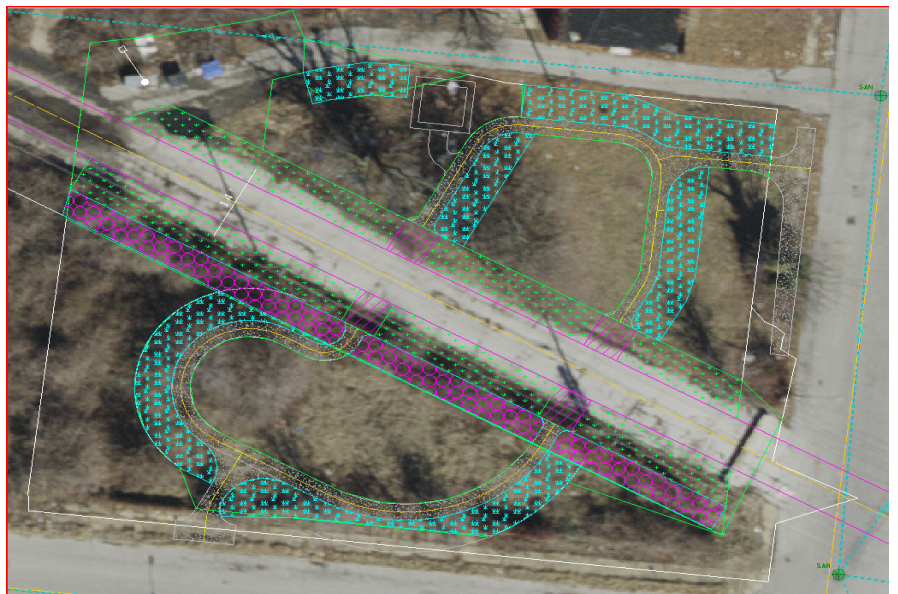
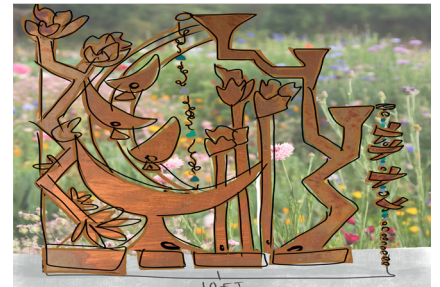

Figure 1.3.1 Delmar Boulevard highlighted between DeBaliviere Ave and Vandeventer Ave

Creative Placemaking Hodiamont Tracks



Lewis Place Park design has been approved by MSD! Estimate for MSD contribution is \$60-90,000 for the construction. Once the property is purchased construction can begin. Frank Wilson from BFW Constuction and a resident of the West End will be our contractor and his Washinngton University students are anxious to begin.





Currently, two park projects are active on the Hodiament Tracks: one in Lewis Place and one in Vandeventer

Vandeventer residents approved the resident artist designed topiary of the man, woman and child family structure. A sample design for the park has been submitted to residents as well. Engineers will begin the process for the park in 2025 with installtion in late 2025.

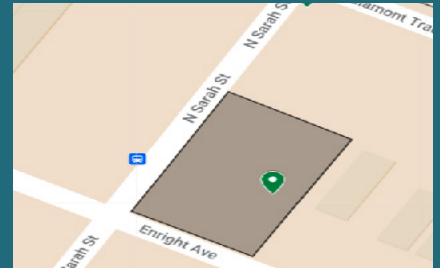

Creative Placemaking Delmar

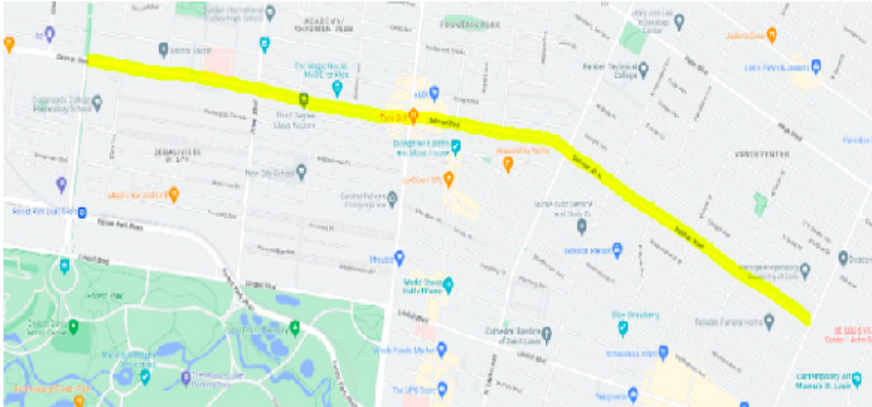
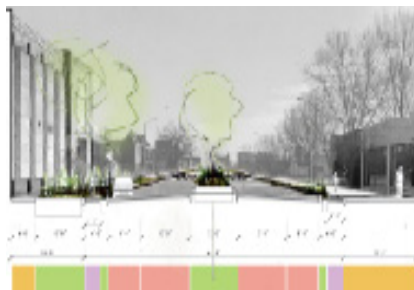
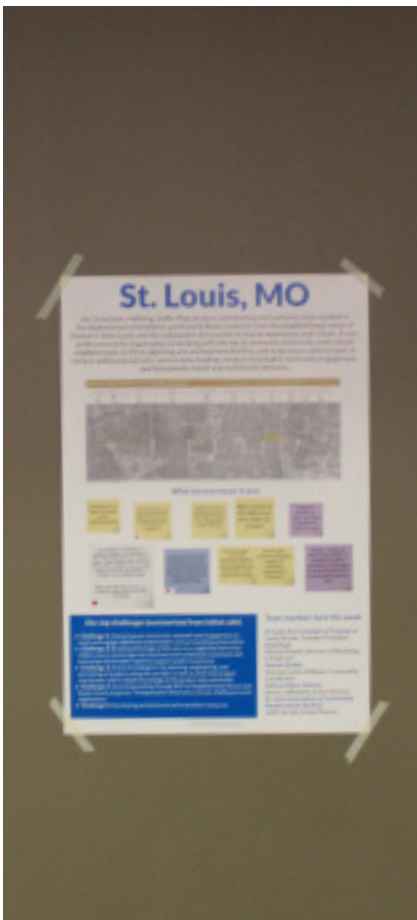

Figure 1.3.1 Delmar Boulevard highlighted between DeBaliviere Ave and Vandeventer Ave

We received the Community Connectors grant from Smart Growth America funded by Robert Woods Johnson Foundation to create the master plan document to address issues not only along Delmar Boulevard but to bring the nine neighborhoods surrounding it together to break the Delmar Divide.

Concept 3A

- 2 driving lanes + 2 parking lanes
- Expanded planted street buffer or expanded sidewalk
- Planted median
- Planted active crosswalk
- Protected bike lanes next to sidewalk
- 2' planted bike buffer





Extending from the Hodiamont Tracks, we received capacity building funds to create a master plan for the nine neighborhoods surrounding Delmar.

We will be including the program priorities within the nine communities as well as projects for the road itself. Options include changing Delmar to two lanes with dedicated bike lanes and pedestrian walkways thus slowing traffic and increasing safety, painting crosswalks and intersections for waymaking, renovating the 14 medians with native plants to work toward a 40% tree canopy, address air pollution, heat island effects and address flooding in the area, add distinctive lighting to the medians for pedestrian safety at night, and formalize the cultural distinctions of the area through artwork. Gateway Foundation has agreed to create a sculpture for one of the medians.



Creative Placemaking Downtown



Partners for the project include not only Artori Group but also Downtown CID and Greater St. Louis Inc. Since the plan is already in place complete with recommendations, we are moving forward with the funding and implementation stages for the artwork and greenspace recommendations.

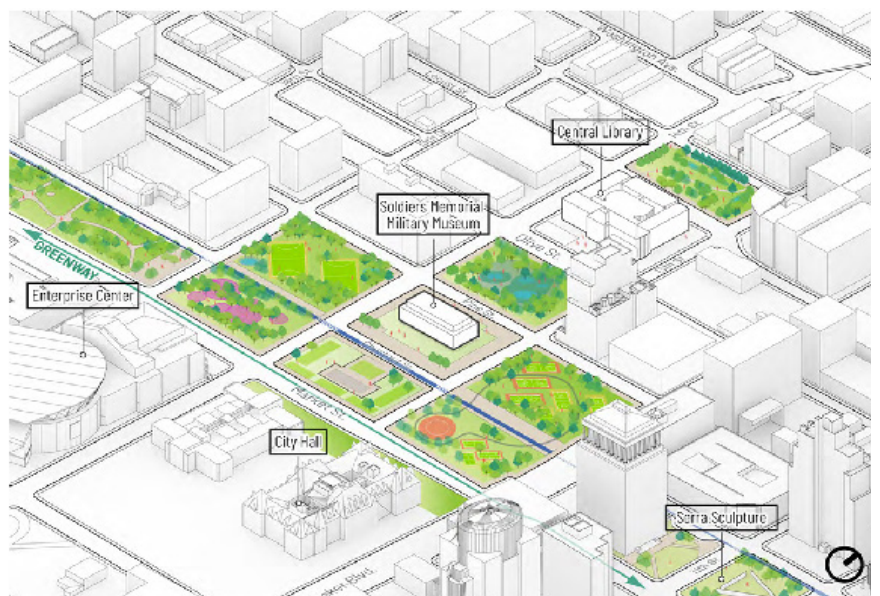
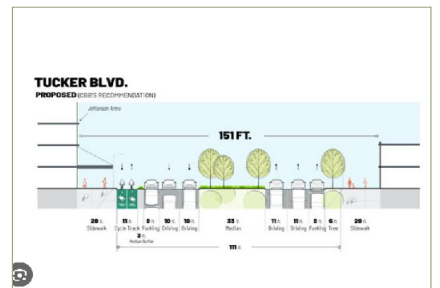
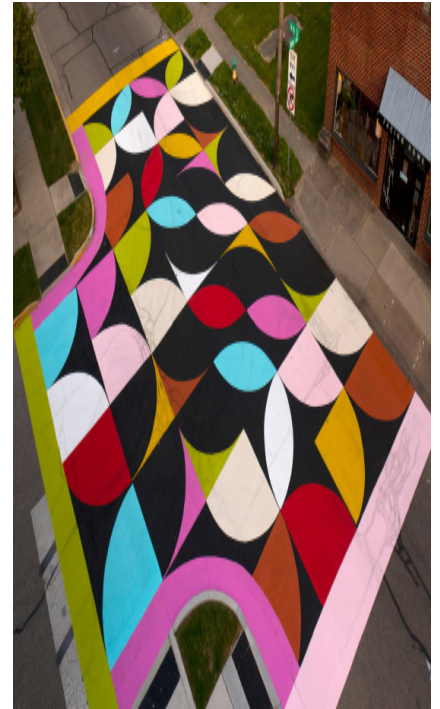



Artori Group partnered with us for Thinksgiving to plan implementation of the Design Downtown Plan

The Design Downtown Plan is a comprehensive plan based upon community input to develop the downtown and downtown west areas by addressing its issues while creating an inviting place for residents, businesses and visitors to gather. Great Rivers Greenway is working on Market Street while our project will address Tucker Boulevard.

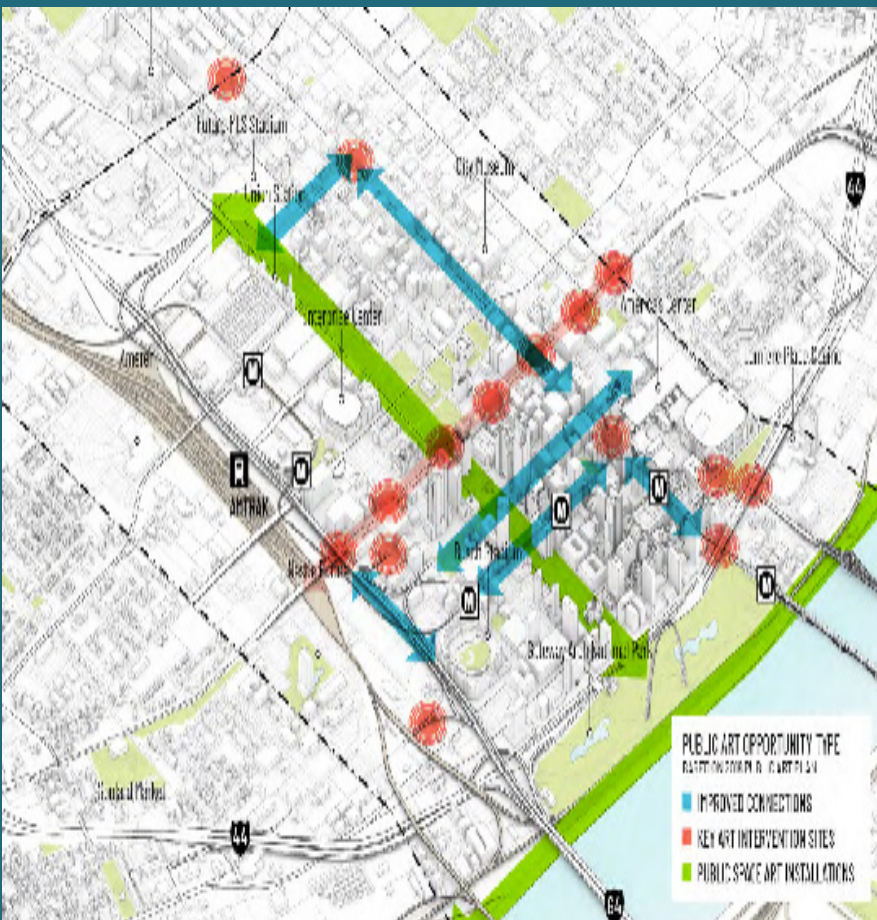

Creative Placemaking Gravois Jefferson

MARQUETTE PARK ANALYSIS

Mark Anthony and Shigeo

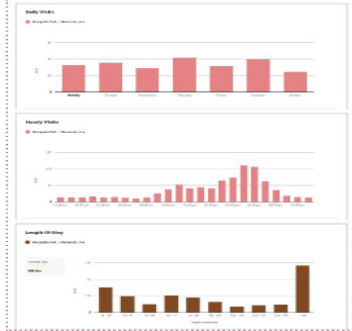

FEB 1, 2020 - JULY 31, 2022

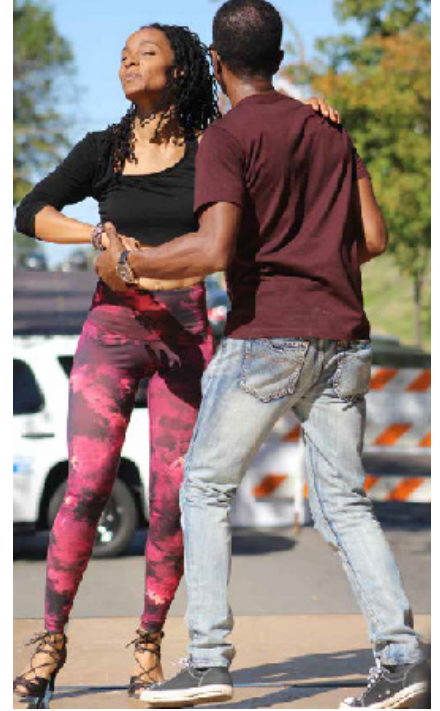

We have been invited to participate in the arts committee once they are set up. This will involve creating the cultural expressions of these very diverse neighborhoods.

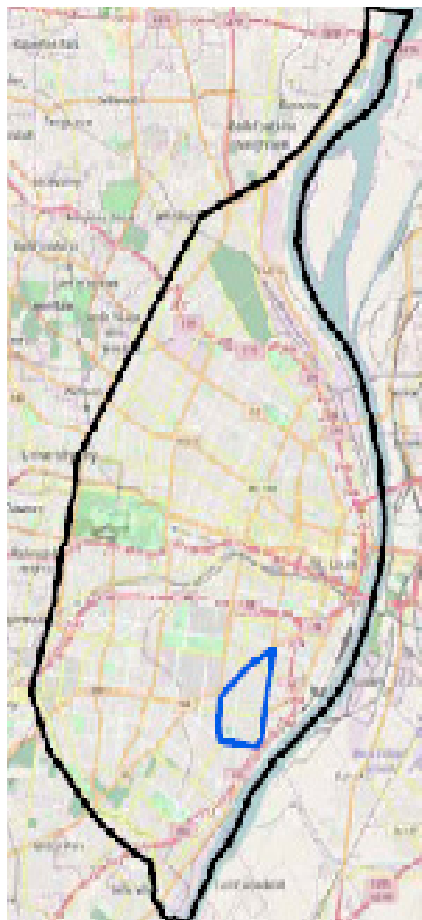

Marquette Park Revitalization

Neighborhood Gem - Analyzing at a glance.
 Marquette Park is an anchor of the Dutchtown South Community and strives to provide spaces for multi-generational use. This park has a number of athletic fields, an exterior playground, community programs and resources, stands as the city's largest free pool, and amongst all; plenty of viable space to roam around and meet with others. With so many positive attributes to offer, Marquette suffers the most from poor maintenance, minimal connectivity, scarce seating, and undeveloped public spaces. It is now that we re-think Marquette Park and provide a new and improved neighborhood destination.

Existing CONDITIONS & ANALYSIS

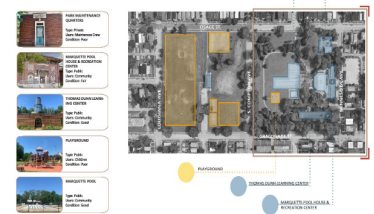

Marquette Park Analysis

Connections, Comfortability, Topographic Changes

Comfortability

There is an abundance of trees throughout the site and each section. These provide multiple areas of natural shading. With this in mind, benches are located near the soccer field and pool, but many are too shaded since many of these benches are in poor condition and located improperly. These issues will be corrected to provide these areas with adequate shade and improvement to the park while using them.

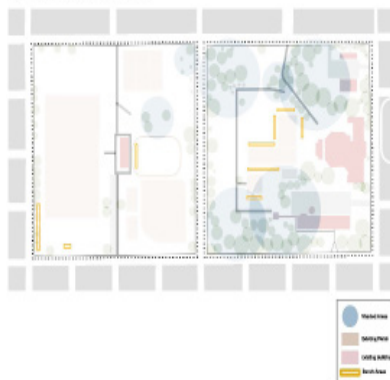

Topographic Changes

There are three primary locations at the park where there are distinct topographic changes. These points provide different views and experiences that can improve user ideas and activities. For example, near the outdoor playground, the hillside creates a wall that could be transformed into an archway that uses the natural hill's incline.



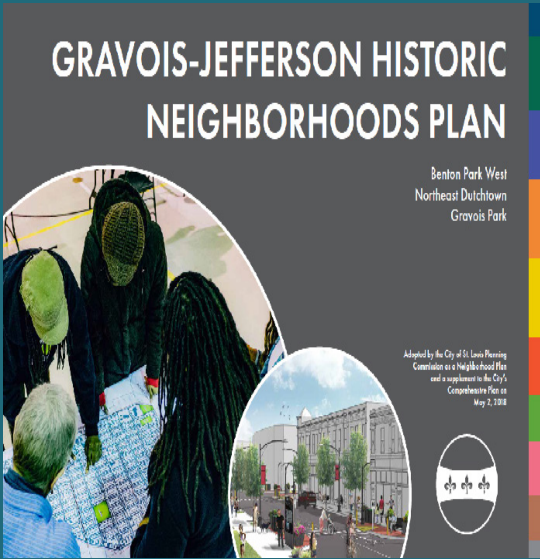



The newest community we are working with is the Gravois Jefferson Neighborhood Community

The community has an extensive and well documented plan developed with extensive community engagement. The committees are active and represent the community. We have been asked to work with the Marquette Park committee to address flooding, landscaping and art in the largest community park.





Existing CONDITIONS & ANALYSIS

- 

3 SET TENNIS COURT
Type: Public
Users: Community
Condition: Good
- 

SOCCER FIELD
Type: Public
Users: Community
Condition: Fair
- 

HISTORIC FIELD HOUSE
Type: Semi-Public
Users: Community
Condition: Good
- 

3 SET VOLLEYBALL COURT
Type: Public
Users: Community
Condition: Fair
- 

BASEBALL FIELD
Type: Public
Users: Community
Condition: Fair

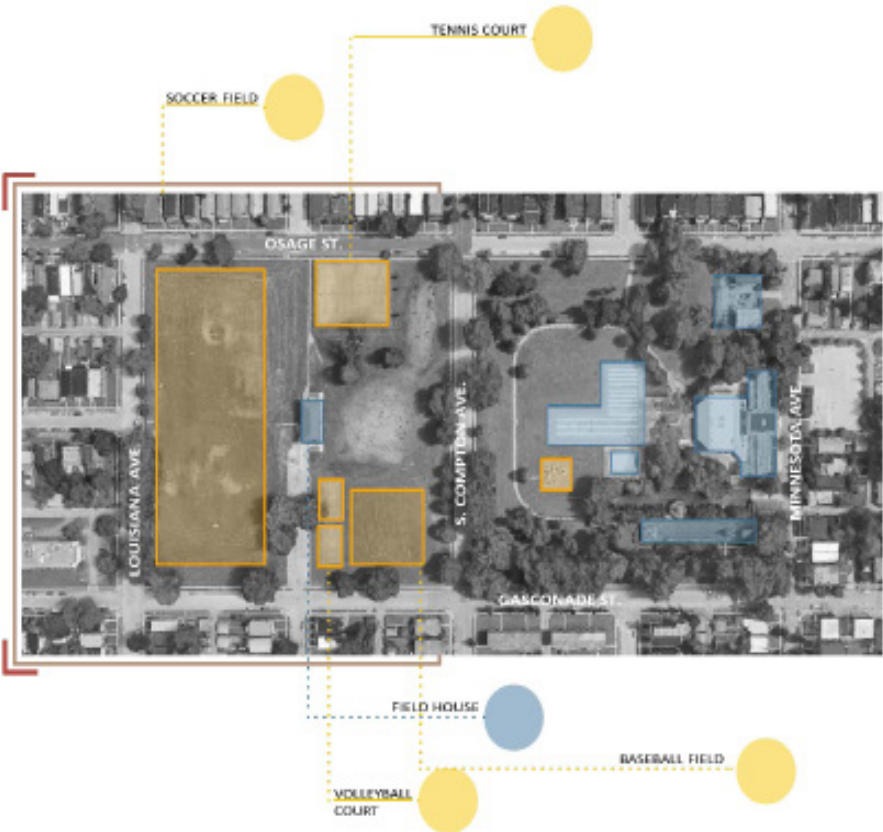

Exhibitions and Performances: Mill Creek, NEA Big Read and Your Words STL.



We were invited to join Your Words STL to assist in their project bringing together 93 students from Loyola in the city and Priory in the County to create peace poles at St. Louis Artworks. We will be installing them along the Hodiament tracks by the mural wall and the Lewis Place park.

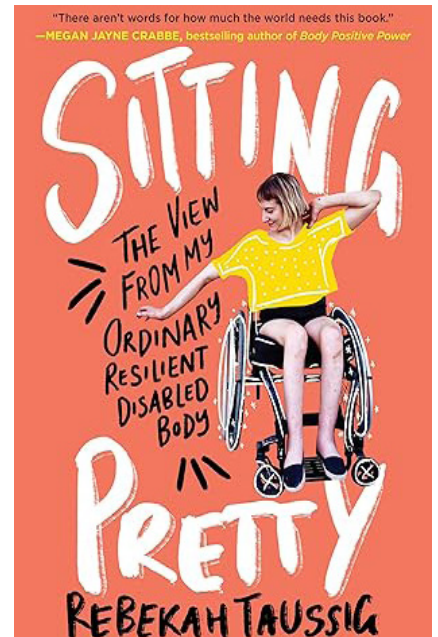



We have three active exhibitions: Mill Creek Valley Installation, NEA Big Read and the Your Words STL Peace Pole Project

Ehenda nientis dolupis et rentiuntem facculpa quodis dolo blatusd aeseri corernam non rem quidi blaut etur am es si in non reperit, quiaeru menisusam, niscimin consed quist, od enimagnim et alit faciasitiaee eatios denditiis doluptiis a que aut explabora quo evelign atessunt.

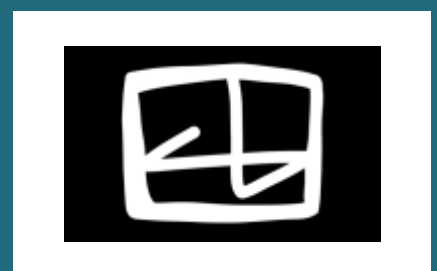

Administration

Development

We submitted 12 grants and received 8 of them ranging from national grants such as NEA Big Read and Smart Growth America Community Connectors to smaller local grants from Regional Arts Commission. Pitch Partners with Washington University and Brightside Blitz.

Marketing

Programmatic

Higher Education Channel TV (HEC TV) created a video about the Hodiamont Tracks Mural and other programs in the Lewis Place Park area. You can watch it on the viewer on the next page. We are working into 2024 to include Google 3D and Aerial Views as options for marketing our large community projects.

Organizational

For our organizational marketing we completed the 1,3 pager and the presentation. The five year plan has been updated so that we can move forward on a more organized approach of our marketing.



“It can be stated with confidence that [the painted jersey barriers project] has made a huge difference in the look and feel of the street. They remain in good condition and have set a precedent for how to quickly and affordably beautify the city streets”

— Greater St. Louis Inc., Great Rivers Greenway, and the Arch Foundation

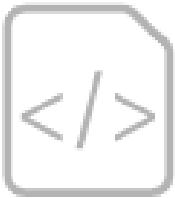

Financials

Financial Statement

St Louis Arts Chamber of Commerce
Statement of Financial Position
 As of December 31, 2023

	TOTAL
ASSETS	
Current Assets	
Bank Accounts	
100 St Louis Arts Chamber of Commer	17,615.63
In Kind Clearing	0.00
PayPal Bank	0.00
Total Bank Accounts	\$17,615.63
Accounts Receivable	
Accounts Receivable (A/R)	0.00
Total Accounts Receivable	\$0.00
Other Current Assets	
12000 Undeposited Funds	0.00
Inventory Asset	0.00
Uncategorized Asset	0.00
Total Other Current Assets	\$0.00
Total Current Assets	\$17,615.63
Other Assets	
18600 Other Assets	0.00
Total Other Assets	\$0.00
TOTAL ASSETS	\$17,615.63
LIABILITIES AND EQUITY	
Liabilities	
Current Liabilities	
Accounts Payable	
20000 Accounts Payable	6,000.00
Total Accounts Payable	\$6,000.00
Credit Cards	
PNC CORE Credit card (3897)	0.00
US Bank Credit Card	0.00
Total Credit Cards	\$0.00
Net Revenue	2,854.73
Total Equity	\$5,043.11
TOTAL LIABILITIES AND EQUITY	\$17,615.63

Statement of Activity

St Louis Arts Chamber of Commerce

Statement of Activity
January - December 2023

	TOTAL
Revenue	
43300 Direct Public Grants	
43340 Nonprofit Organization Grants	34,848.00
Total 43300 Direct Public Grants	34,848.00
43400 Direct Public Support	
43410 Corporate Contributions	116.28
43445 Gifts in Kind-Services	81,995.00
43450 Individ, Business Contributions	11,609.93
Total 43400 Direct Public Support	93,921.21
44500 Government Grants	
44510 Agency (Government) Grants	2,000.00
44520 Federal Grants	18,000.00
Total 44500 Government Grants	20,000.00
46400 Other Types of Income	
46430 Miscellaneous Revenue	0.08
Total 46400 Other Types of Income	0.08
47200 Program Income	54.46
47210 Program Sales	377.26
Total 47200 Program Income	431.72
Total Revenue	\$149,201.01
GROSS PROFIT	\$149,201.01
Expenditures	
60000 Advertising and Promotion	569.98
60300 Awards and Grants	
60340 Specific Assist to Individuals	200.00
Total 60300 Awards and Grants	200.00
60400 Bank Service Charges	40.00
60900 Business Expenses	
60920 Business Registration Fees	10.45
Total 60900 Business Expenses	10.45
62100 Contract Services	31,995.00
62150 Outside Contract Services	163.75
Total 62100 Contract Services	32,158.75
62800 Facilities and Equipment	
	TOTAL
65000 Operations	489.56
65010 Books, Subscriptions, Reference	2,567.66
65020 Postage, Mailing Service	66.00
65040 Supplies	194.27
Total 65000 Operations	3,317.49
65100 Other Types of Expenses	
65120 Insurance - Liability, D and O	932.00
65170 Staff Development	2,756.03
Total 65100 Other Types of Expenses	3,688.03
66000 Payroll Expenses	8,294.00
67000 Program Specific Expenses	6,868.00
67010 Advertising/Promotional	340.77
67020 Cost of Labor	
67021 Contractors	65,638.97
67022 Payroll	13,576.88
67023 Awards and Contracts	15.00
Total 67020 Cost of Labor	79,230.85
67060 Office/General Administrative Expenditures	66.00
67070 Other Business Expenses	656.60
67080 Supplies & Materials	1,591.44
Total 67000 Program Specific Expenses	88,753.66
Total Expenditures	\$137,690.65
NET OPERATING REVENUE	\$11,510.36
Other Expenditures	
Reconciliation Discrepancies	8,655.63
Total Other Expenditures	\$8,655.63
NET OTHER REVENUE	\$ -8,655.63
NET REVENUE	\$2,854.73

Outcomes and Impact

We are working with Washington University to implement our impact measurements for all of our programs with funding from the Community Connectors grant. A range of measures for impact include data from baseline for five years forward on

- climate such as average street temperatures in the neighborhoods, bird and butterfly populations, and tree effects;
- use of the parks including types and number of events and numbers of people including demographic make up.
- property values in a 3 block radius around the creative placemaking projects.
- traffic safety with statistics from the Missouri Traffic Safety Data broken down by neighborhood
- crime in a 3 block radius around the creative placemaking projects with neighborhood statistics from St Louis Metropolitan Police Department.
- neighborhood conservation efforts and school/after school programming for students in this area.
- numbers of books distributed and rates of school retention for students in the area.

Feedback from residents in Lewis Place has been very positive as evidenced in support from those living across from the Park, to the redevelopment of the dilapidated buildings across from the park to the fact that the Mural Wall has not been damaged.

Once offered to assist in other community projects such as RR Marketplace, Gravois Jefferson NEighborhoods and Downtown Community Improvement District, we were welcomed with open arms. A key goal was to be a respected resource for communities in the area. We have succeeded.



Cbabi will be using antique doors that face the street with murals of people living in their homes like those destroyed bin Mill Creek Valley.

A handwritten signature in black ink that reads "Hardy Brooks Ed. PPT/PCSAFC". The signature is written in a cursive, flowing style.

Thank you to our Grantors, Donors and Volunteers

Grantors

Brightside Nature's Naturescaping
Forest ReLeaf
Greater St. Louis Inc.
Regional Business Council
Regional Arts Council
National Endowment for the Arts

Donors

St. Louis Composting
Frank Wilson

Engineers Without Borders
St. Louis Street Department
And Our Board!

And of course all of our amazing volunteers!